



**EUROPEAN  
ALUMINUM  
SYSTEMS**

**ALUMINC CANADA LTD.**

7250 Keele St, Unit 203 Concord

tel: 1.888.691.7701

e-mail: [info@aluminc.ca](mailto:info@aluminc.ca)

[www.aluminc.ca](http://www.aluminc.ca)

**IP OUT**

**IMPERIAL OUT**



The system Imperial OUT is designed for tilt out and turn out windows.

# IP OUT

Window system designed for designing tilt out and turn out windows.

System Imperial OUT is fully compatible with window system Imperial (they share system elements: connectors, gaskets, glazing strips).

System Imperial OUT features faced internal surface of the frame and the sash.

Turn out windows can be fitted with two types of hinges: rotating hinges or scissor hinge; window hardware used allows tilting the top or the bottom of the window outwards; option of turn out window with the limit stop.

Available option of integrating windows with walls by using reversing profile.

The option of bending profiles (detailed specification of profiles and detailed technical parameters of profile bending process are available in the authorisation zone of the website [www.aliplast.pl](http://www.aliplast.pl)).

Maximum dimensions and weights of structures in Imperial OUT system:

- *tilt out windows* - minimum width and height of sash 500 mm, maximum width and height of sash 2000 mm, maximum weight of sash 100 kg for tilt out windows
- *turn out windows* - minimum width and height of sash 500 mm, maximum width of sash 1500 mm, height of sash 3000 mm, maximum weight of sash 120 kg for turn out windows

System IP OUT is available in the variant with improved thermal insulation power. Available options:

- *IP OUT i* with additional thermal insulation, at the profile-glass interface;
- *IP OUT i+* with additional thermal insulation between thermal spacers.

This system is very popular in Nordic countries and on British Isles. Perfectly matching old and stylized manor houses, wood cabins or simple Scandinavian type houses. Shutters are often used with such windows.

There is possibility of use Flyscreen system (Flyscreen – fly screens are a practical and an extremely functional protection against insects).

Wide range of colours – RAL palette (Qualicoat 1518), texture colours, Aliplast Wood Colour Effect (wood-like colours), Aliplast Loft View – colours imitating stone surfaces (Qualideco PL-0001), anodized colour (Qualanod 1808), bi-colour.

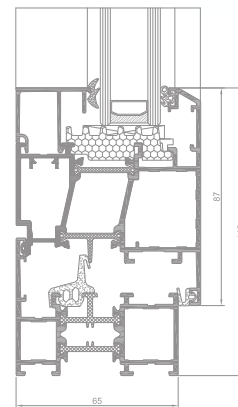

IP OUT i window section

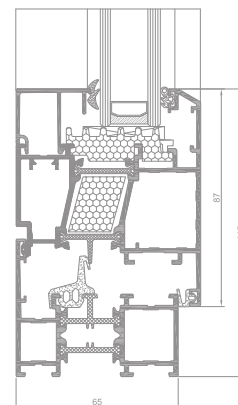

IP OUT i+ window section

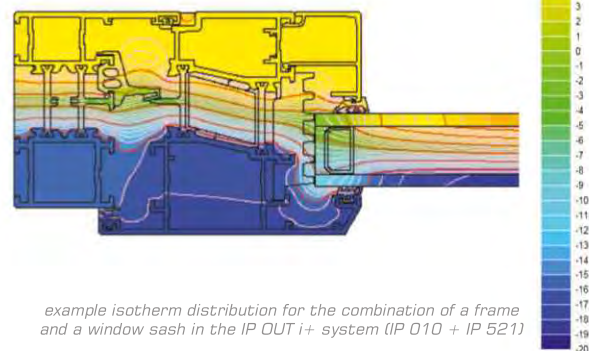

example isotherm distribution for the combination of a frame and a window sash in the IP OUT i+ system (IP 010 + IP 521)

## TECHNICAL SPECIFICATION

SYSTEM	MATERIAL	DEPTH OF FRAME	DEPTH OF LEAF	GLAZING RANGE	MAXIMUM WINDOW SIZES	MAXIMUM DOOR SIZES
IP OUT	aluminium / polyamid	65 mm	74 mm	max 51 mm	single-leaf window 1456 x 2356 mm	_____
IP OUT i+	aluminium / polyamid	65 mm	74 mm	max 51 mm	single-leaf window 1456 x 2356 mm	_____

## PERFORMANCE

SYSTEM	THERMAL INSULATION Uf *	AIR PERMEABILITY	WINDLOAD RESISTANCE	WATERTIGHTNESS
IP OUT	Uf from 1,85 W/m <sup>2</sup> K	Class 4; EN 12207	Class C5/B5; EN 12210	Class E900; EN 12208
IP OUT i+	Uf from 1,68 W/m <sup>2</sup> K	Class 4; EN 12207	Class C5/B5; EN 12210	Class E900; EN 12208

\* Thermal insulation is dependent on a combination of profiles and thickness of the filling.